

Mixed Reality (MR)



KEY FEATURE

Overlay virtual world on the real world based on technology understanding of the real world



2019 ANNUAL CONFERENCE

Immersive VR Implementation Guide for the Construction Industry



2019 ANNUAL CONFERENCE

What do I do?



IMPLEMENTATION GUIDEBOOK

- Planning
- Tools Selection
- Training
- Model Preparation
- Opportunities



2019 ANNUAL CONFERENCE

Strategy and Use Cases

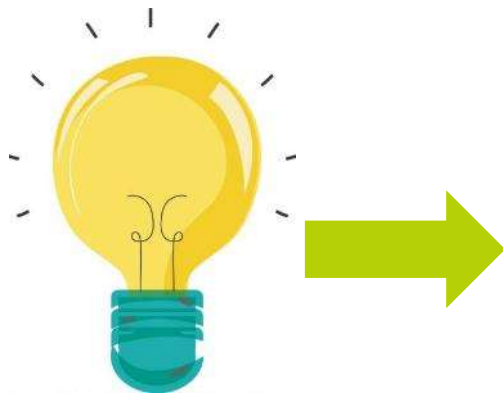

Implementation Strategy
and Use Cases

Hardware and Software
Selection

Training of Users and
Developers

3D Model Preparation for the
Immersive VR Environment

Integration and Further
Developments



Hardware and Software



Implementation Strategy
and Use Cases

Hardware and Software
Selection

Training of Users and
Developers

3D Model Preparation for the
Immersive VR Environment

Integration and Further
Developments



Training Programs



Implementation Strategy
and Use Cases

Hardware and Software
Selection

**Training of Users and
Developers**

3D Model Preparation for the
Immersive VR Environment

Integration and Further
Developments



2019 ANNUAL CONFERENCE

Model Preparation

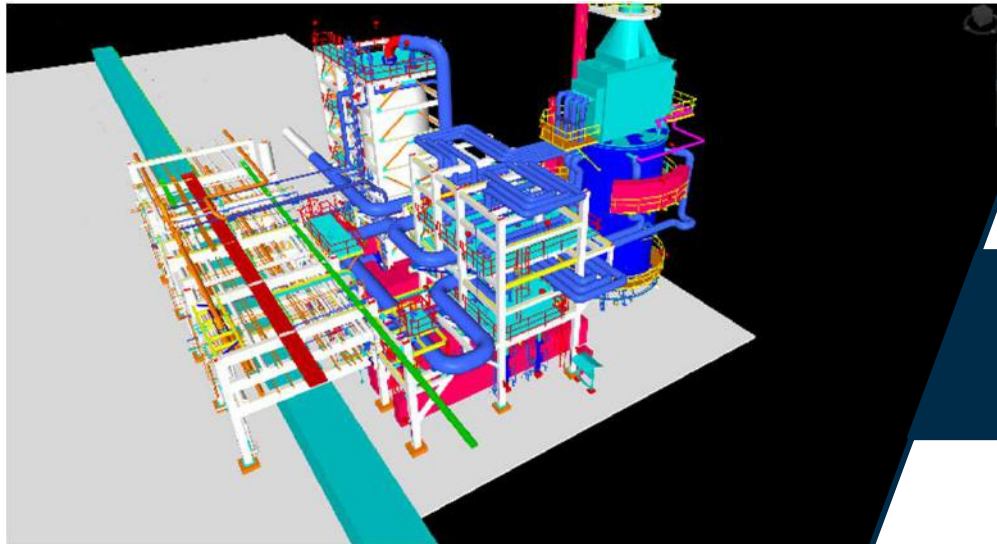

Implementation Strategy
and Use Cases

Hardware and Software
Selection

Training of Users and
Developers

**3D Model Preparation for the
Immersive VR Environment**

Integration and Further
Developments



2019 ANNUAL CONFERENCE

Future Developments



Implementation Strategy
and Use Cases

Hardware and Software
Selection

Training of Users and
Developers

3D Model Preparation for the
Immersive VR Environment

**Integration and Future
Developments**



REAL-WORLD VIRTUAL REALITY USE CASE

Fluor Safety Training Program



2019 ANNUAL CONFERENCE

Fluor VR Safety Training - Fluor Life Critical Campaign

Life Critical focus on the operations we execute that have the greatest potential for serious injury or fatality



Working at height



Cranes and rigging



Motorized heavy equipment



Trenching and excavations



Motor vehicle operation



Electrical work



Material handling



Hazardous energy control / line breaking



Confined space entry

Life Critical promotes our single most important goal
- **Protecting the lives of workers**



Fluor VR Safety Training - Working at Height

1 Put on your HSE Equipment



You start off with your gloves on and put on your hardhat, safety glasses and select a scenario

2 Work At Height



Working at height starts off up on a platform with an open area in the handrail for material delivery

3 Tie off Lanyard



Before you can start, you must tie off your lanyard.

4 Move tripping hazards



Ensure that you move any tripping hazards before proceeding

5 Falling objects



Learn about falling objects and they impacts they can have

6 Spot the hazard



Take some time and spot hazards in the scene

2019 ANNUAL
CONFERENCE



Other Relevant CII Initiatives

*THE
FUTURE
IS HERE
ARE YOU READY?*

CII Global Affiliates Program – The Goal (Create a Global Network)



CII Members Headquartered in **Blue** Countries

*THE
FUTURE
IS HERE
ARE YOU READY?*

THANK YOU